

## Jamestown Slate

## Cabinetry by KWP



### OVERLAY

Full 1¼"

### DOOR STYLE

Jamestown

### DOOR CONSTRUCTION

Mortise and Tenon

### DRAWER FRONT

5-Piece

### FINISH

Stained Slate on Maple

3/8" thick finished ends

### ADDITIONAL FEATURES

- Solid Wood Dovetail Drawers
- Soft Close Doors & Drawers
- ¾" Shelves
- Limited Lifetime Warranty
- Made in Culver, IN

## Cabinet Specifications

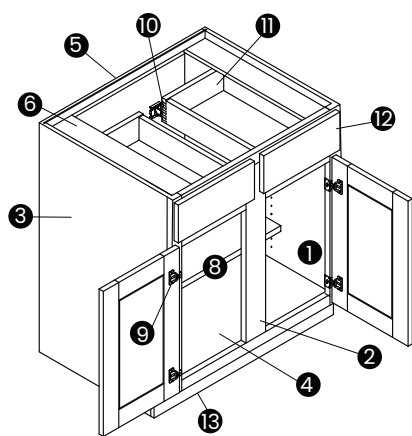

### 1 Interior

Natural Maple Laminate

### 2 Face Frame

3/4" thick solid wood; glued, clamped, and screwed.

### 3 End Panels

3/8" thick laminated furniture board. Interior is light maple wood grain laminate; exterior is wood grain laminate.

### 4 Top and Floor

3/8" thick light maple wood grain laminated furniture board.

### 5 Back

3/8" thick light maple wood grain laminated hardboard.

### 6 I-Beam (base & vanity cabinets)

I-Beams are dadoed into face frame end panel and back panel, providing extra structural support.

### 7 Hanger Rail

Hanger rails are pocket screwed to backs of cabinets for enhanced structural integrity.

### 8 Shelves 3/4" Thick

Wall cabinet shelves will be fully adjustable. Base cabinet shelves will be half depth and fixed into place.

### 9 Hinges

Six-way adjustable soft-close concealed. Limited Lifetime Warranty.

### 10 Drawer Guides

Limited Lifetime Warranty. Drawers glide smoothly on self-adjusting full extension soft-close guides.

### 11 Drawer Box Construction

Four-sided construction featuring dovetail joints. Constructed with 1/2" thick solid wood sides and 1/4" thick plywood captured bottom.

### 12 Drawer Fronts

3/4" thick 5-piece hardwood to match doors.

### 13 Toe Kick

Sub toe kick is 4-1/2" high.

Customer Signature (approval) \_\_\_\_\_ Printed Name \_\_\_\_\_ Date \_\_\_\_\_

I agree to take delivery within 14 days of order placement. **Once I have received the cabinets, I agree to inspect for damage within 7 days.** I understand that neither Schillings nor KWP will be held responsible for damage complaints beyond this time frame.

If returning stock cabinets, all items must be returned in its original packaging, and will be charged a 20% restocking fee. All returns will take place at our Cedar Lake Distribution Center. Any credit will be issued after inspection by the distribution center.

### **Warranty information**

Limited Lifetime Warranty on Drawer Glides and Hinges. Kountry Wood Products warrants to original consumer purchasers for as long as they own their home that they drawer, drawer glides and hinges used in the manufacture of Kountry Wood Products cabinetry shall be free from defects in the material and workmanship under normal use.

5 Year Limited Warranty on Cabinets. In addition, Kountry Wood Products warrants to original consumer purchasers for a period of five years from the original date of purchase that all other components of Kountry Wood Products cabinetry shall be free from defects in material and workmanship under normal use.

This warranty does not cover products that are misused, abused, mishandled, improperly installed, improperly stored, changed, modified, or subject to extreme temperatures or extreme moisture levels. This warranty is not valid for products used for any purpose other than the purpose for which they were intended. This warranty does not cover the cost of installation, removal, subsequent damage, or transportation of the defective product, regardless of whether the work was performed by a contractor, service company, or the consumer.

---

I am purchasing KWP Spring Orchard **Jamestown** door style, **Maple** wood species, with **Slate** stained finish. This finish has a rich color and smooth, flowing grain patterns. Maple wood is known for rich tones that age well, like a vintage wine. The Slate stain emboldens both the grain and rich natural colors in the wood. Natural Maple wood ranges from light pinks to dark browns. Maple will darken or mellow with age, a change that is more noticeable with light stains and usually takes place within the first six months. Sun exposure greatly accelerates this process. Mineral streaks, pitch pockets, pin knots, and sap wood all occur naturally in Maple and are acceptable characteristics.

---

Schillings does not provide installation on cabinetry. Final adjustments to the doors and drawers are necessary and are the responsibility of the installer or the homeowner. If there is a problem that requires a replacement order, Schillings will do what we can to get the replacement product order rushed. However, Schillings cannot guarantee lead times and cannot offer monetary compensation or discounts for any delays. All single door cabinets come hinged **RIGHT**. (Reversing hinging, as needed, is the installer's responsibility.)

Also, please be advised that additional labor costs can be incurred by adding materials that are labor intensive to install (ex: handles, moldings, roll out trays, etc).

Customer Signature (approval) \_\_\_\_\_

Printed Name \_\_\_\_\_

Salesperson \_\_\_\_\_

Deposit Ticket \_\_\_\_\_

Today's Date \_\_\_\_\_ Last Revised 1/6/23